

MAYGA

— DIGITAL PIANO —

INSTRUCTIONS



Preface

Dear users:

Congratulations on your new MAYGA electronic piano. It has advanced functions and good acoustic quality. With its help, you will start your musical journey. Electronic piano will bring you a new playing experience.

Please read the instructions carefully, so that you can make better use of it and play its performance.

Please keep it in a safe place, so that you can use it in the future.

Important Items

Before using this product, please read the following important items.

- Before using the AC transformer to power the product, you must check whether the AC transformer has any damage.
- Please check the power code carefully to see if it is broken, bare or has other damage. Do not let children use seriously damaged AC transformer.
- Children under 3 years old are not allowed to use the product.
- Users can only use the original transformer.
- AC transformer is not a toy.
- Before cleaning, you must remove the AC transformer.

Product Parameters

- Imported 88-key progressive keyboard with hammer touch
- 200 kinds of voice
- 200 kinds of rhythm
- The maximum polyphony 128
- Metronome
- Automatic temperament stabilization system(tuning-free)
- MIDI input/output
- Audio input/output
- Stereo dual headphone jack
- Connect to Apple products/ Android products/Windows products
- Transpose
- 100 pieces of demonstration music
- Output power 15W × 2
- Accessories: host, piano rack three-pedal, instructions, power adapter
- Color: White/Black both colors can be chosen
- Dimension: Length 1380mm x Width 415mm x Height 832mm

Packing List

Dear users, please check whether the following items are complete after choosing.

- Host
- Piano rack
- Instructions
- Power adapter
- Three-pedal
- Serial No

Contents

Prepare Before Use	3
Power connection	3
Socket on the back of the host	3
Three-pedal interface	4
Control panel	5
Voice	5
Rhythm	6
Demo song	6
Start accompaniment	6
Comprehensive chords	6
Metronome	7
Strength	7
Transpose	7
MIDI	7
Voice list	8
Voice list	9
Voice list	10
Rhythm list	11
Demo song list	12
Body assembly instructions	13
Suggestion feedback	14

Notes

Before using, please read the following items carefully, and keep the document in a safe place for future reference.

Warning

When using the product, please comply with the following items to operate, so as to avoid serious injuries or death to users due to electric shock, short circuit, accident, fire or other dangers. The items that users need to pay attention to. Note the following, but not only this.

Do not open the electric piano or attempt to disassemble the components, and do not make any changes to the inside. This product does not have the parts that users can repair themselves. (The electronic piano has automatic temperament stabilization system, so it is unnecessary to tune) If there is dysfunction, please contact qualified repairers for checking and maintenance.

Avoid exposing the electronic piano to rain, or using it near watery and humid places. Do not place containers with water on the electronic piano, because moisture may flow into the interior of the electronic piano.

If the power cord or plug is worn or damaged, or if power is suddenly cut off during use, and you smell a strange odor or the electronic piano emits smoke, you should turn off the power immediately, remove the power plug, and ask a qualified repairer to check and maintain.

Please ensure that the power supply voltage is 220 V \pm 10% AC, too high or too low voltage will cause damage to the piano.

Before cleaning the electronic piano, you should turn off the power, remove the power plug. Do not operate with wet hands while the electricity is used. Do not wipe and clean the electronic piano with corrosive solvents.

Regularly check the power switch and the power cord. When changing the fuse, be sure that you have removed the power plug, and ensure the use of the same fuse with the original specifications.

Notice

Users should also obey the following rules during use, which can avoid the damage to the users or others, and the electronic piano or other external devices. The items that users need to pay attention to, are shown as follows, but not limited to these.

Do not place the AC power cord near heat sources, such as a heater. Do not over-bend the power cord, put heavy objects on the power cord, place the power cord in a place where people go and wrap other things on the power cord to avoid damaging the power cord.

When removing the power plug of the product, please take the plug itself, instead of pulling the cord.

Please remove the power plug if the electronic piano will not be used for a long time or when it thunders.

Do not place this electronic piano in a dusty, vibrating, cold or hot environment (such as under the impact of direct sunlight, near the heating device or in the transportation tool in the sun) to avoid damaging the appearance of the electronic piano and the internal components.

Before moving the electronic piano, you should remove the power cord and the wires connected to other equipment.

When cleaning the electronic piano, please wipe it with a dry and soft cloth. Do not use paint thinner, organic solvents, detergents, or other chemicals with erosion effect to wipe the electronic piano, so as not to discolor the panel or keyboard.

When the user connects the electronic piano to other devices, firstly, please turn off all the power switches. Before turning off the power switch, please set the volume to its minimum. When using the instrument, first set the electronic piano's volume to its minimum then gradually increase the volume until it fits.

Do not place the electronic piano near other appliances, such as TV, radios, speakers, etc. Placing it near other appliances may cause interference between electrical appliances.

Do not place the electronic piano in an unstable place so as not to cause the electric piano to fall down.

Do not put heavy objects on the electronic piano, do not use excessive force to press the keys and toggle the control switch.

In order to apply to the classroom, auditorium and other occasions, this electronic piano has been designed to have enough volume redundancy. The volume can be adjusted. You should adjust it to the proper value. If you use unreasonable excessive volume for a long time, this doesn't conform to the common sense of music, but also may cause hearing loss.

Avoid the electronic piano encounter a strong collision. Collisions may cause damage to the electronic piano and cause personal injury.

Prepare Before Use

This chapter will introduce the function jacks related to the electronic piano and give out some information before playing. Before opening the power switch of the electronic piano, please read the following items.

Power connection

1. Confirm whether the power switch is turned off, if it is not, please turn off the power switch.
2. Connect the power cord, firstly insert the plug into the DC jack on the back of the electronic piano then plug the other end of the power adapte into the power outlet.
3. Before opening the power, adjust all volume controllers to the minimum.
4. When turning off the power of the electronic piano, first tune all volume controllers to the minimum then turn off the power switch.

Warning

When you don't use the electronic piano, or when it thunders, please remove the power plug.

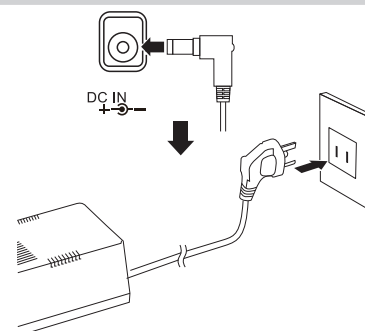
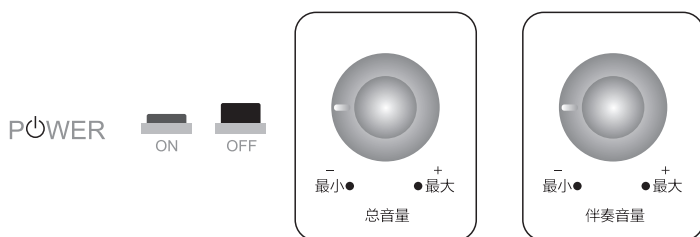

Warning

Please ensure that the power supply voltage is $220V \pm 10\%$ AC, too high or too low voltage will cause damage to the electronic piano. And the power socket should be a triangle, it should be grounded.

Do not remove the power cord from the power socket when the electronic piano is still opened.

Socket on the back of the host

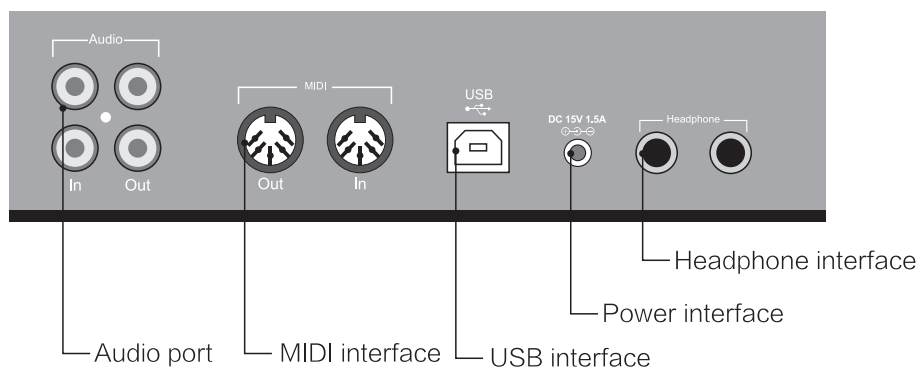

Three pedal interface

Three – pedal

According to the traditional grand piano, the electronic piano is manufactured. It adopts a damper pedal, a sostenuto pedal and a soft pedal which are same to that of the traditional grand piano. Step on the pedal to open; Release the pedal to close.

Please connect the pedal cord to the pedal connector at the bottom of the piano.

Damper pedal

(Right) After depressing the damper pedal, notes will be extended; After releasing, the portamento effect is closed immediately.

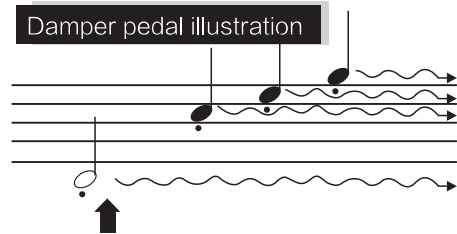

Sostenuto pedal

(Middle) Press and hold the note key while depressing the pedal, which can prolong the pressed note (as if depressing the damper pedal) but the subsequent notes will not stretch. This can lengthen the chord or single bass note while playing other sounds in a staccato way.

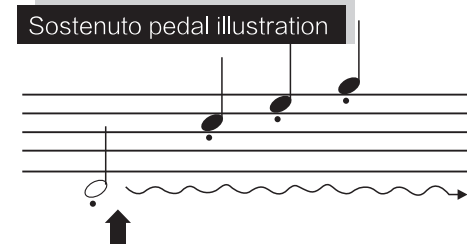

Soft pedal

(Left) Depress the soft pedal to reduce the volume of the note that you are playing, at this time, the timbre changes. The notes played before depressing the pedal are not affected.

If you press and hold the note, while depressing the back damper pedal, this can extend the note until the pedal is released.



Before depressing the pedal, be sure that you have instacked the pedal support screw and it is fully grounded.

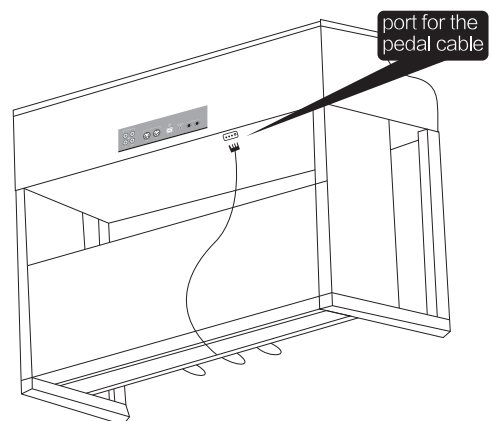
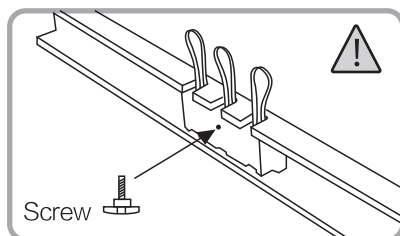

 Control panel

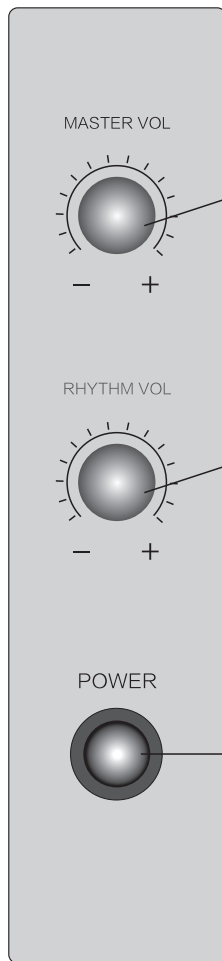
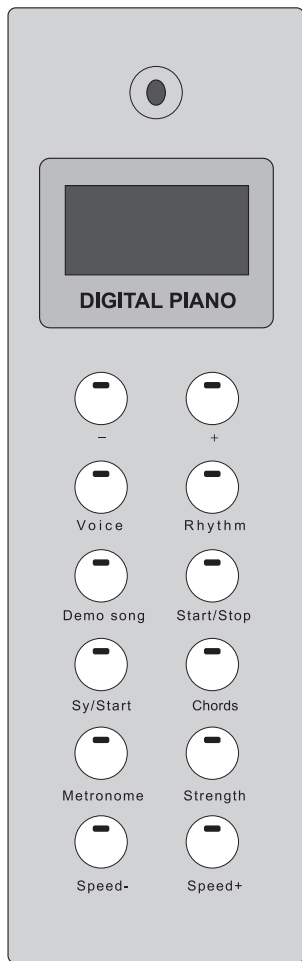
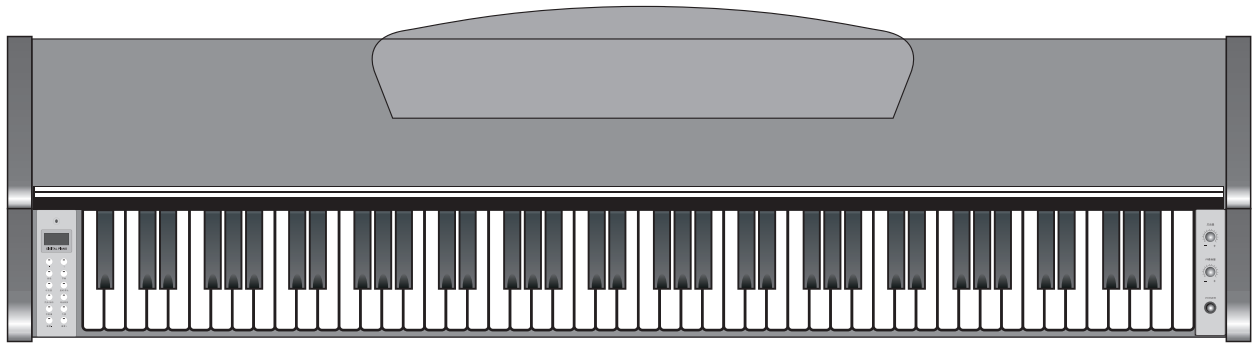

• **MASTER VOL**

Turn the knob of total volume to adjust the main volume of the piano.

• **RHYTHM VOL**

Turn the knob of accompaniment volume to adjust the piano's accompaniment volume, demo music volume, metronome volume.

• **SWITCH**

Before opening the power switch of the host, please tune all volume down to the minimum.

 Voice

- ◆ The product contains 1000 kinds of voice. (refer to voice list for details)
- ◆ The default voice is grand piano after starting (000).
Press the [voice] button to display, and the voice can be changed by pressing the [+/-] button.
- ◆ Double-click voice to return to the grand piano voice.

Rhythm

- ◆ 200 rhythms, 000–200. (refer to rhythm list for details)
- ◆ The default rhythm is 000 after starting, press the [rhythm] button to enter the rhythm selection status, use the [+/-] button to select the corresponding rhythm.

Adjust the accompaniment speed

- ◆ Use the [speed-] [speed +] buttons to adjust the accompaniment speed, the adjustable range is :20–280 beats per minute.
- ◆ Select the rhythm when the accompaniment stops, and the speed is automatically set to the preset value of the rhythm; Switch the rhythm while the rhythm is playing, the speed does not return to the preset value.
- ◆ Press both [speed -] [speed +] at the same time, and the speed will be recovered to the preset value immediately.

Demo song

- ◆ Press the [demo song] button to start the demo song. Use the [+/-] button to select tracks, press the [demo song] button again to stop the demo song (refer to demo song list for details)

Start accompaniment

The product has two modes of accompaniment starting:

- ◆ Press the [sync/start] button to enter the accompaniment preparation status. Start playing, accompaniment will be automatically started, press the [start/ stop] button, accompaniment will be stopped.
- ◆ Press the [start / stop] button, and the accompaniment will be started immediately; Press the [start/ stop] button again and the accompaniment will be stopped immediately.

Comprehensive chords

The product contains two chord modes

- ◆ Single finger and multiple fingers. Press the [comprehensive chords] button to turn on the automatic chord function. If you play on the left of the keyboard at this time, it can tell single finger or multiple fingers, and match the corresponding chord.
- ◆ Press the [comprehensive chords] button again to turn off the automatic chord function.

Metronome

- ◆ Press the [metronome] button to start , the default tempo is the first piece of the rhythm' s tempo.
- ◆ Use [speed -] [speed +] buttons to adjust the metronome' s tempo . The range is 20–280beats/minute.
- ◆ Press [metronome] again to log out metronome function,and the present tempo will be stored.
Attention: Restart the digital piano will recover to the default tempo.

Beat set

- ◆ Long press the [metronome] button to enter the metronome type selection status.
- ◆ Use the [+/-] button to select the corresponding beat type: (1/4, 2/4, 3/4, 4/4, 5/4, 6/4).
- ◆ Press the [metronome] button after the selection or no operation more than 5 seconds to confirm the beat type selection.

Strength

- ◆ 3 strength curves can be set: light, standard, heavy (t00–102) and strength button.
- ◆ The default strength after starting is t01.
- ◆ Press the [strength] button repeatedly to enter the strength curve setting, and select the corresponding curves :t00–t02, tof.

Transpose

- ◆ Press [+/-] these two buttons at the same time to enter the selection of the transposition function state.
- ◆ Use the [+/-] buttons to select the corresponding transposition.
The transposition range is +-12 halftone.
- ◆ After the selection is completed, press [voice] or [rhythm] to exit the selection of the transposition status.

MIDI

- ◆ MIDI is short for Musical Instrument Digital Interface, is about digital signal and connector' s world standard name.
- ◆ We can transmit musical data between musical instruments made by different companies and computers (machines) through MIDI, realize arrangement, compose, computer recording and so on.
- ◆ There is a USB port at the back of the digital piano, and standard MIDI output and input ports, please turn off the power of the digital piano before connect with computers or other machines.

 **Attention** Windows 2000/XP need to download USB MIDI drive program software

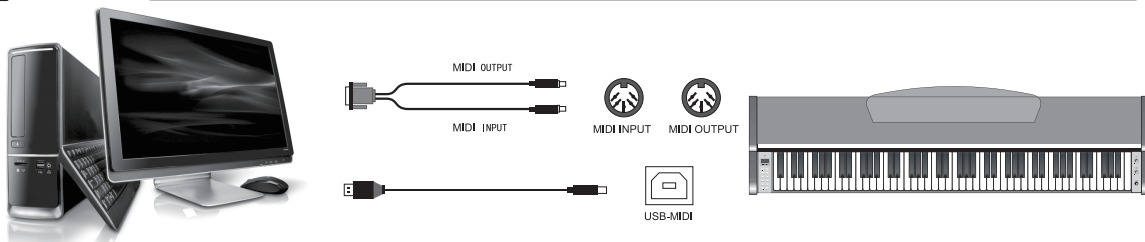

 Voice List

No.	Chinese Name	English Name
000	大钢琴	Acoustic Grand Piano
001	亮音钢琴	Bright Acoustic Piano
002	电钢琴	Electric Grand Piano
003	酒吧钢琴	Honky-tonk Piano
004	电钢琴 1	Electric Piano 1
005	电钢琴 2	Electric Piano 2
006	大键琴	Harpsichord
007	古钢琴	Clavichord
008	钢片琴	Celesta
009	钟琴	Glockenspiel
010	八音盒	Music box
011	抖音琴	Vibraphone
012	玛林巴	Marimba
013	木琴	Xylophone
014	管钟	Tubular Bells
015	扬琴	Dulcimer
016	爵士风琴	Hammond Organ
017	敲击风琴	Percussive Organ
018	摇滚风琴	Rock Organ
019	教堂风琴	Church Organ
020	簧风琴	Reed Organ
021	手风琴	Accordian
022	口琴	Harmonica
023	探戈手风琴	Tango Accordion
024	古典吉他	Acoustic Guitar (nylon)
025	民谣吉他	Acoustic Guitar (steel)
026	爵士电吉他	Electric Guitar (jazz)
027	清音电吉他	Electric Guitar (clean)
028	闷音电吉他	Electric Guitar (muted)
029	超载电吉他	Overdriven Guitar
030	失真电吉他	Distortion Guitar
031	吉他泛音	Guitar Harmonics
032	大贝司	Acoustic Bass
033	弹指电贝司	Electric Bass (finger)
034	拨片电贝司	Electric Bass (pick)
035	无品贝司	Fretless Bass
036	拍击贝司1	Slap Bass 1
037	拍击贝司2	Slap Bass 2
038	合成贝司1	Synth Bass 1
039	合成贝司2	Synth Bass 2
040	小提琴	Violin
041	中提琴	Viola
042	大提琴	Cello
043	低音提琴	Contrabass
044	颤弓弦乐	Tremolo Strings
045	弹拨弦乐	Pizzicato Strings
046	竖琴	Orchestral Harp
047	定音鼓	Timpani
048	合奏弦乐1	String Ensemble 1
049	合奏弦乐2	String Ensemble 2
050	合成弦乐1	Synth Strings 1
051	合成弦乐2	Synth Strings 2
052	人声(啊)	Choir Aahs
053	人声(嘟)	Voice Oohs
054	合成人声	Synth Voice
055	管弦乐队断奏	Orchestra Hit
056	小号	Trumpet
057	长号	Trombone
058	大号	Tuba
059	加弱音器小号	Muted Trumpet
060	圆号	French Horn
061	铜管合奏	Brass Section
062	合成铜管1	Synth Brass 1
063	合成铜管2	Synth Brass 2
064	高音萨克斯	Soprano Sax
065	次高音萨克斯	Alto Sax
066	中音萨克斯	Tenor Sax

No.	Chinese Name	English Name
067	次中音萨克斯	Tenor Sax
068	双簧管	Oboe
069	英国管	English Horn
070	大管	Bassoon
071	单簧管	Clarinet
072	短笛	Piccolo
073	长笛	Flute
074	竖笛	Recorder
075	排箫	Pan Flute
076	吹瓶声	Bottle Blow
077	日本尺八	Shakuhachi
078	哨声	Whistle
079	陶笛	Ocarina
080	合成主音1 (方波)	Lead 1 (square)
081	合成主音2 (锯齿波)	Lead 2 (sawtooth)
082	合成主音3	Lead 3 (calliope lead)
083	合成主音4	Lead 4 (chiff lead)
084	合成主音5	Lead 5 (charang)
085	合成主音6	Lead 6 (voice)
086	合成主音7	Lead 7 (fifths)
087	合成主音8	Lead 8 (bass+lead)
088	合成音色1 (新世纪)	Pad 1 (new age)
089	合成音色2 (温暖)	Pad 2 (warm)
090	合成音色3	Pad 3 (polysynth)
091	合成音色4 (合唱)	Pad 4 (choir)
092	合成音色5	Pad 5 (bowed)
093	合成音色6 (金属声)	Pad 6 (metallic)
094	合成音色7 (光环)	Pad 7 (halo)
095	合成音色8	Pad 8 (sweep)
096	合成效果1 (雨声)	FX 1 (rain)
097	合成效果2 (音轨)	FX 2 (soundtrack)
098	合成效果3 (水晶)	FX 3 (crystal)
099	合成效果4 (大气)	FX 4 (atmosphere)
100	合成效果5 (明亮)	FX 5 (brightness)
101	合成效果6 (魅影)	FX 6 (goblins)
102	合成效果7 (回音)	FX 7 (echoes)
103	合成效果8 (科幻)	FX 8 (sci-fi)
104	西塔琴	Sitar
105	班卓琴	Banjo
106	三味线	Shamisen
107	十三弦筝	Koto
108	卡林巴	Kalimba
109	苏格兰风笛	Bagpipe
110	古提琴	Fiddle
111	山奈	Shanai
112	叮当铃	Tinkle Bell
113	阿哥哥鼓	Agogo
114	钢鼓	Steel Drums
115	木鱼	Woodblock
116	太鼓	Taiko Drum
117	通通鼓	Melodic Tom
118	合成鼓	Synth Drum
119	铜钹	Reverse Cymbal
120	吉他磨弦声	Guitar Fret Noise
121	呼吸	Breath Noise
122	海浪	Seashore
123	鸟叫	Bird Tweet
124	电话铃	Telephone Ring
125	直升机	Helicopter
126	鼓掌声	Applause
127	枪声	Gunshot
128	宽广的大钢琴	Piano w
129	暗淡的大钢琴	Piano d
130	小手风琴	Bandoneon
131	二胡	Er Hu
132	古筝	Gu Zheng
133	尤克里里	Ukulele

No.	Chinese Name	English Name
134	管风琴1	Organ 1
135	管风琴2	Organ 2
136	口琴2	Harmonica 2
137	电吉他2	Clean Gt 2
138	电吉他3	Clean Gt 3
139	柳琴	Liu Qin
140	琵琶	Pi Pa
141	西塔琴2	Sitar 2
142	柔和的吉他	Mellow Gt
143	合唱吉他	Chorus Gt
144	簧风琴2	Reed Organ 2
145	60年代管风琴	60's Organ
146	合成器1	Synth 1
147	合成器2	Synth 2
148	合成器3	Synth 3
149	合成器4	Synth 4
150	合成器5	Synth 5
151	中阮	Zhong Ruan
152	大阮	Da Ruan
153	曼陀林	Mandolin
154	曼陀林2	Mandolin 2
155	月琴	Yue Qin
156	三弦	San Xian
157	合成弦乐3	SynStrings 3
158	吹瓶声2	Bottle Blow 2
159	尺八箫2	Shakuhachi 2
160	小提琴2	Violin 2
161	小提琴3	Slow Violin
162	中提琴2	Viola 2
163	大提琴2	Cello 2
164	大键琴2	Harpsichord 2
165	大键琴3	Coupled Hps
166	大键琴4	Harpsio
167	古琴	Gu Qin
168	夏威夷吉他	Hawaiian Gt
169	唱诗乐(啊)2	Choir Aahs2
170	唱诗乐(嘟)2	Voice doo 2
171	合成人声2	Synth Voice2
172	摇滚风琴2	Rock Organ 2
173	教堂风琴2	Church Organ 2
174	教堂风琴3	Church Organ 3
175	笙1	Shen 1
176	笙2	Shen 2
177	铜管乐2	Brass 2
178	合成铜管3	Synth Brass 3
179	方波2	Square 2
180	正弦波	Sine Wave
181	锯齿波2	Saw 2
182	医生	Doctor Solo
183	人声主奏	Vox Lead
184	短笛2	Piccolo 2
185	长笛2	Flute 2
186	太空声音	Space Voice
187	合成木槌	Syn Mallet
188	明亮2	Brightness 2
189	魅影2	Goblin 2
190	回音铃	Echo Bell
191	回音盘	Echo Pan
192	编钟	Bian Zhong
193	扬琴2	Yang Qin 2
194	直笛2	Recorder 2
195	排笛2	Pan Flute 2
196	小号2	Trumpet 2
197	长号2	Trombone 2
198	长号3	Trombone 3
199	排鼓	Pai Gu

Rhythm List

No.	Name
001	BLUES
002	6.8BLUES
003	4.4BLUES
004	5.4BEAT1
005	5.4BEAT2
006	BOOGIEWOOGIE
007	soulshuffle
008	RAGTIME1
009	RAGTIME2
010	SHUFFLE1
011	SHUFFLE2
012	SHUFFLE3
013	SHUFFLE4
014	BLUES1
015	BLUES2
016	BLUES3
017	BLUES4
018	TWIST1
019	TWIST2
020	TWIST3
021	TWIST4
022	GOSPEL1
023	GOSPEL2
024	GOSPEL3
025	R&B
026	SWING1
027	SWING2
028	BLUEBOOGIE
029	JAZZ
030	JAZZ1
031	JAZZ2
032	JAZZ3
033	JAZZ4
034	JAZZ5
035	JAZZBALLAD
036	JAZZWALTZ
037	JAZZBAND1
038	JAZZBAND2
039	JAZZBAND3
040	SWINGJAZZ
041	COOLJAZZ
042	DIXIELAND1
043	DIXIELAND2
044	FUSION
045	LANGE
046	SOUL1
047	SOUL2
048	SOUL3
049	FOX TROT
050	FOXTROT1
051	FOXTROT2
052	FOXTROT3
053	FOXTROT4

No.	Name
054	FOXTROT5
055	FOXTROT6
056	FOXTROT7
057	FOXTROT8
058	FOXTROT9
059	COUNTRY
060	COUNTRY1
061	COUNTRY2
062	COUNTRY3
063	COUNTRY4
064	COUNTRY5
065	COUNTRY6
066	COUNTRY7
067	COUNTRY8
068	COUNTRY9
069	COUNTRY10
070	COUNTRY11
071	COUNTRY12
072	COUNTRY13
073	COUNTRY14
074	COUNTRY15
075	COUNTRY16
076	COUNTRYPOP
077	COUNTRYSHUFFLE1
078	COUNTRYSHUFFLE2
079	COUNTRYSWING
080	LATIN
081	LATIN1
082	LATIN2
083	LATIN3
084	LATIN4
085	LATIN5
086	LATIN6
087	TANGO1
088	TANGO2
089	RUMBA1
090	RUMBA2
091	RUMBA3
092	CHACHA1
093	CHACHA2
094	CHACHA3
095	CHACHA4
096	CHACHA5
097	CHACHA6
098	BOSSANOVA
099	BOSSANOVA1
100	BOSSANOVA2
101	BOSSANOVA3
102	SAMBA1
103	SAMBA2
104	SAMBA3
105	MAMBO1
106	MAMBO2

No.	Name
107	MAMBO3
108	REGGAE1
109	REGGAE2
110	SALSA1
111	SALSA2
112	MODERN1
113	MODERN2
114	DANCE
115	DANCE1
116	DANCE2
117	DANCE3
118	DANCE4
119	DANCE5
120	DANCE6
121	DANCE7
122	70DISCO1
123	70DISCO2
124	DISCO1
125	DISCO2
126	DISCO3
127	VAPERWAVE
128	FUNK
129	FUNK1
130	FUNK2
131	FUNK3
132	FUNK4
133	FUNK5
134	FUNK6
135	FUNK7
136	R&B
137	R&B1
138	R&B2
139	R&B3
140	R&B4
141	R&B5
142	R&B6
143	POP
144	16BEAT1
145	16BEAT2
146	16BEAT3
147	16BEAT4
148	16BEAT5
149	16BEAT6
150	16BEAT7
151	16BEAT8
152	POP1
153	POP2
154	POP3
155	POP4
156	POP5
157	POP6
158	POP7
159	POP8

No.	Name
160	VINTAGE1
161	VINTAGE2
162	FOLKPOP
163	NEWAGE
164	POPBOSSA1
165	POPBOSSA2
166	POPRAP
167	POPSAMBA
168	ROCK
169	8BEAT1
170	8BEAT2
171	8BEAT3
172	8BEAT4
173	8BEAT5
174	8BEAT6
175	8BEAT7
176	8BEAT8
177	8BEAT9
178	8BEATROCK1
179	8BEATROCK2
180	Rock1
181	Rock2
182	Rock3
183	Rock4
184	Rock5
185	INDIEROCK1
186	INDIEROCK2
187	60thRock
188	GlamMetal1
189	GlamMetal2
190	GlamMetal3
191	PunkRock1
192	PunkRock2
193	PunkRock3
194	PunkRock4
195	PunkRock5
196	JIVEROCK
197	ROCKSHUFFLE
198	ROCK'N'ROLL1
199	ROCK'N'ROLL2
200	ORIENTAL
201	BEGUINE1
202	BEGUINE2
203	CARIBBEAN
204	BOLERO
205	DANGDUT
206	CHINA
207	JIANGNAN
208	XIZANG
209	YUNNAN
210	HAWAII
211	GUARACHA
212	CHARLESTON

Demo song

No.	Name
S00	FUNK
S01	RIVER_OF_DREAM
S02	DANCING QUEEN
S03	DONNA_LEE
S04	FORGET
S05	CHOPIN:GRANDE VALSE BRILLANTE
S06	ACROSS THE SEA
S07	XAVER SCHARWENKA:POLISH DANCE Op.3 No.1
S08	RED CHERRY AND WHITE APPLE BLOSSOM
S09	COUNTRY_GARDEN
S10	COURANTE
S11	JUST DRUNK
S12	CARRY ME BACK TO OLD VIGINNY
S13	EARLY_AUTUMN
S14	TWIST VARIATION
S15	DANSE NEGRE Op.58
S16	PALM LEAF
S17	D MAJOR TANGO
S18	SYMPHONY NO.94 SURPRISE
S19	KATYUSHA
S20	DESAFINADO
S21	BEETHOVEN_BAGATELLES
S22	IN THE HALL OF THE MOUNTAIN KING
S23	EXPLORING
S24	PERELUDE III
S25	GRAND MARCH
S26	PARAPHRASE
S27	DANGEROUS AREA
S28	FUTURE
S29	SUNSHINE BEACH
S30	JUNE SAMBA
S31	KENNYG:SONGBIRD
S32	L'INVERNO IN F MINOR
S33	WINE
S34	BLUES
S35	FEELING
S36	TURKEY
S37	ETUDE IN F SHARP MAJOR
S38	FUNNY GENTLEMAN
S39	I DO IT FOR YOU
S40	BEETHOVEN PIANO SONTA No.30
S41	CARMEN
S42	AMERICAN PATROL
S43	MENDELSSOHN:RONDO IN D MAJOR
S44	AURORA OF CITY
S45	WISH U CHRISTMAS
S46	NO STOPPING GALOP
S47	LAST SUMMER
S48	JAZZ
S49	RHYTHM OF THE RAIN

No.	Name
S50	TWINKLE TWINKLE VARIATION
S51	ATLANTIS
S52	FLYING TRAPEZE
S53	TROIS ECOSSAISES Op.72,No.3-5
S54	ALLEGRO CON BRIO
S55	LEMON TREE
S56	ARABESQUE
S57	CHILDHOOD
S58	JUST THE TWO OF US
S59	SEE SHORE
S60	ALL KIND OF MY EVERYTHING
S61	NOCTURNE Op.9 No2
S62	SOMETHING IN THE AIR
S63	COMFORT
S64	LET IT SNOW
S65	BINGO
S66	LIEBESTRAUM
S67	PERFECT HAPPINESS
S68	TOCCATA
S69	LA BAMBA
S70	RANDO CAPRICCIO
S71	SCHERZO
S72	LA CAMPANELLA
S73	LOCKOUT
S74	ROMANCE DE AMOR
S75	BARCAROLE
S76	CHOPIN:ETUDE IN C MINOR Op.10 No.12
S77	DANCE OF YOUTH
S78	GRIEG_AIR
S79	THE HOME COMING
S80	LAZY_BIRD
S81	RED RIVER VALLEY
S82	ENTERTAINMENT
S83	CHOPIN:MAZURKA Op.39 No.10
S84	THE BEAR IN THE FOREST
S85	PRIMITIVE DANCE STEPS
S86	MODERN GRAY
S87	MOONLIGHT
S88	LOVE FOREVER
S89	JARDIN SECRET
S90	BALL
S91	COUNTRY
S92	SOMALILAND
S93	MAPLE LEAF RAG
S94	BRAHMS_CONCERTO
S95	WALTZ IN D FLAT,OP.64 NO.1
S96	COBWEB
S97	HAPPY BOSSA
S98	SILENT NIGHT
S99	CURIOUS STORY

Body assembly instructions

- To ensure the correct assembly of the Piano, read this manual carefully before assembly and place the manual where it is readily available for inspection.
- Please remove the main unit from the box and remove the protective cover and foam box. (Packaging and packaging materials must be kept for half a month).
- During assembly or handling, keep the device raised horizontally.
- Be careful of handling, be careful not to pinch your hands, or drop the device to your feet.
- Before you screw the screw to the final position, gently tighten the screw slightly more easily. Wait until the screw has entered about normal time and then increase the force. Do not use excessive force when screwing to the final position of the screw, which may damage the screw.
- After tightening the screws, place the device in a flat and stable place. Do not place it in a fluffy stall or on the ground. In this case, the pedals are easily swayed, resulting in skin lesions.
- Do not place the main body of the device directly on the floor. This will damage the bottom of the interface and bracket, and damage the host's bottom panel.
- Open the box, check the box items, such as the screw package is complete.
- Caution: Be sure to install the pedal to support the bolt. The black plum plastic part of the pedal support handle bolt should be unscrewed until it touches the ground (This largest bolt is to play the role of supporting the pedal force).

Installation steps

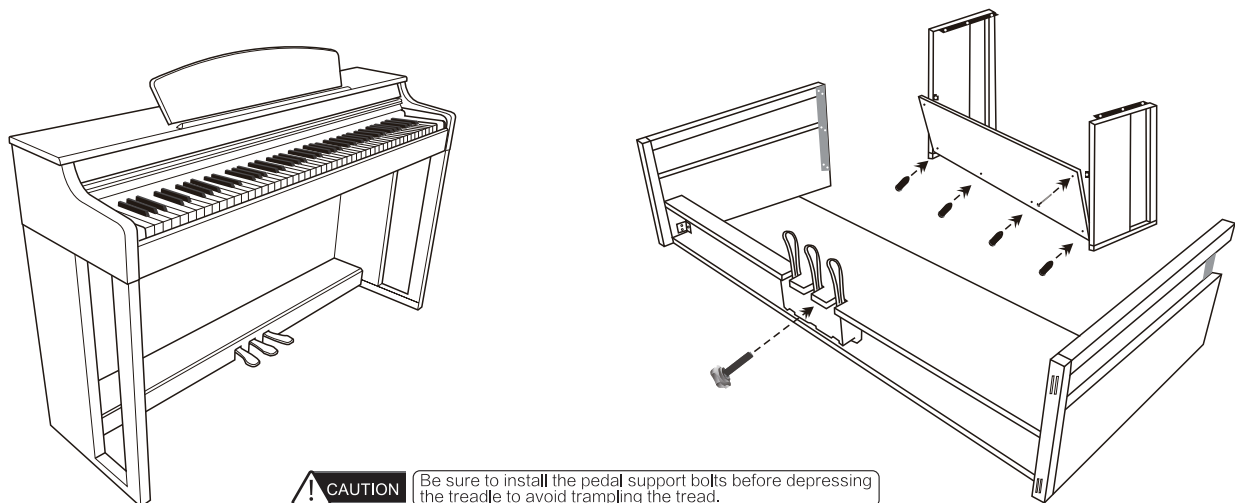
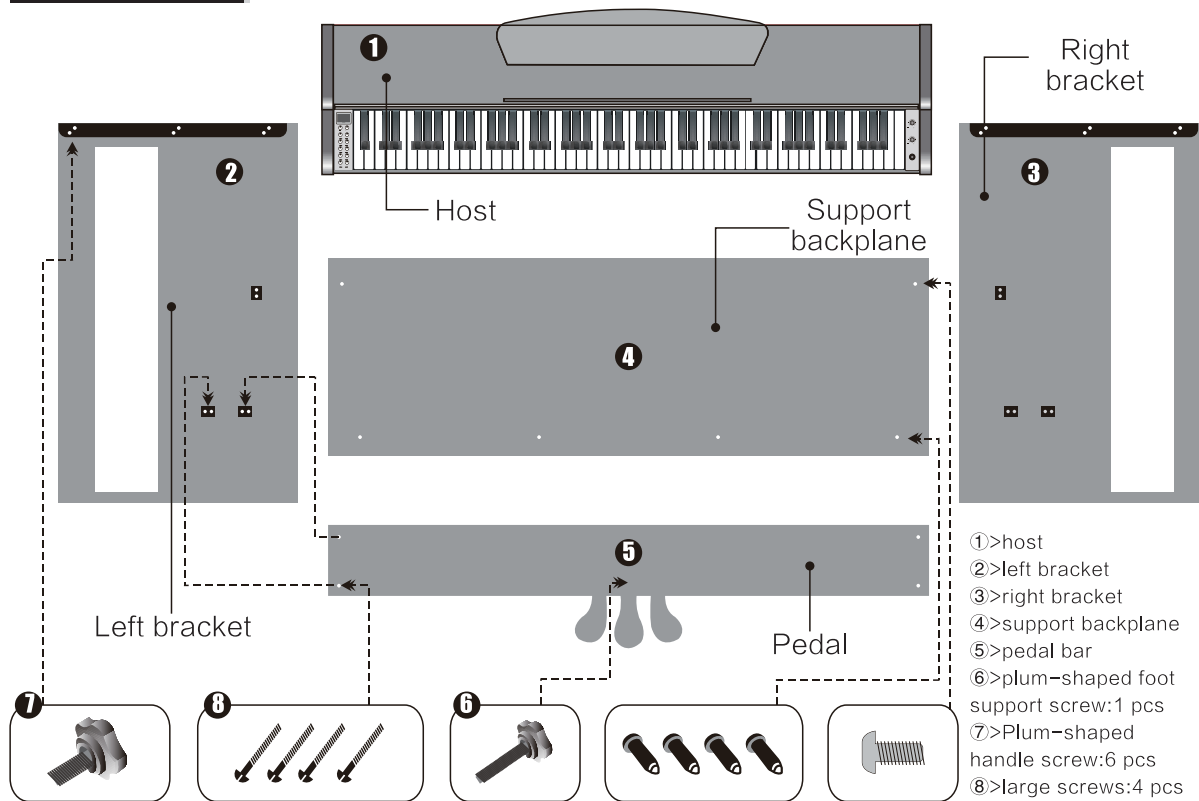

CAUTION Be sure to install the pedal support bolts before depressing the treadle to avoid trampling the tread.

Services and products advice to Qingdao Mayga Instrument Co.,Ltd

※Contact information can be found on the back cover of this manual

MAYGA Electronic Instrument Warranty

This product, through quality inspection, is qualified. After sales, if there is any failure under the normal use state, the user can enjoy the service of free repair within the prescribed scope specified on the back of the warranty in accordance with the articles of the warranty.

Please keep the warranty well. If you lose it, the company will not provide another one.

This warranty is valid only in the main land of the People's Republic of China, Hong Kong, Macao and Taiwan.

*To the sales stores

Owing to the warranty, the user has the right to get the service of free repair. It is a certificate. Therefore, please ask the buyer to fill in the following table even though this product is regarded as a gift or souvenir, and deliver the warranty to the customer.

Model/product Name		
Code / Date of Manufacture		
Customer	Name	Phone Number
	Address	Post Code
Store	Name of the Store	Phone Number
	Address	Post Code
	Stamp	
Warranty Period		One year from the purchase date(day, month, year)

Guarantee Regulations

1. If failures occur under the normal use state, or failures occur while the user follows the requirements of instructions, the user can enjoy the service of free repair within one year from the day on which the product is sold.
 2. When requiring warranty service, please contact the store in which you purchased the product or the designated maintenance stations, while you should take your product and warranty to go there.
 3. If your product conforms to any of the following items, you need to pay for the maintenance even though it is in the period of warranty.
 - (1) Failures occur or the product is damaged due to improper carrying, transportation or storage.
 - (2) Failures occur or the product is damaged due to misuse, abuse or improper use.
 - (3) Failures or damage is caused by fire, earthquake, flood, lightning, rats and other disasters or caused by theft.
 - (4) Failures or damage is caused by irregular repair, modification or abnormal voltage.
 - (5) The warranty is not shown or the necessary items of the warranty are not filled (such as purchase date, name of the store, etc.)
 - (6) Failures occur or the product is damaged since its battery runs out.
 4. This warranty is valid only in the main land of the People's Republic of China, Hong Kong, Macao and Taiwan.
- ※ Users' legal rights are not subject to the warranty.

To users

1. When you purchase the product, please be sure to fill in the purchase date.
2. Except for special circumstances (such as the loss caused by theft, natural disasters, etc.), this warranty will not be reissued, please keep it well.
3. If your address changes, when the product needs to be repaired, please contact the designated repair stations.